



OVERVIEW

FRANKLIN HILLS RESIDENTS ASSOCIATION
 ISSUE No. 8 WINTER 1992

FRANKLIN AVENUE MEDIAN UPDATE:

We Can't Afford to Fill the Blank Yet.

By Ricardo Accorsi

The Franklin Avenue Median Beautification Project has been making progress at a very rapid rate. The permit plans are nearly complete and preliminary approval by the City has been received. The Project is in its final planning challenge: The financial race. The referee is in place to give the go-ahead with the starter's gun. "On your marks. . Get set. . . Click." That's right. We can't afford to fill the blank median yet. The Project is quite literally on track, but now needs its neighbors' financial support to get to the finish line.

FHRA has accrued nearly \$6000 of the projected installation cost of \$10,000. A part of these funds were received in direct response to the last issue of *The Overview*, where the Project was introduced. Small and large pledges alike were made and we are hopeful that our readers' interest will be sustained, or even increased with this issue. The design has evolved gracefully into a complementary series of "landscapes" which take the median's horticultural context as a prime source of inspiration. The sketches illustrate the design which received preliminary approval from the city.

Large contributions have been made by significant individual and organizational donors from our own and nearby communities. FHRA is appealing to businesses in the area for their financial support, too. FHRA will gratefully ~~acknowledge every donor and participant in a future issue.~~ *The Overview*, when we hope the Project will be complete.

The Project calls for an irrigation system, which is in the final design stage, and will be submitted to the City for final approval shortly. During the approval period, bids will be

See Median, p. 14

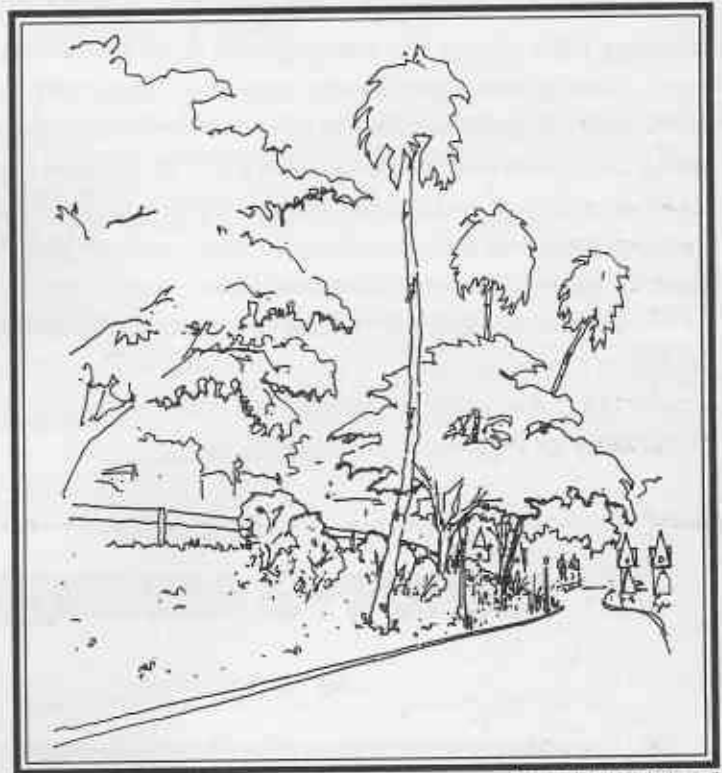

Drawing by Ricardo Accorsi

Proposed Franklin Avenue landscaping, looking east toward bridge.

How did it happen? Where's 92?
Another year gone, so much yet to do.
Poverty, crime and hunger all grew.
Political mud didn't block that view.
Year's end . . . let' bid old woes adieu.

Have high hopes to start off '93
On Franklin's median, help plant a tree.
Love thy neighbor, let them love thee.
Instruct your children it's "we" not "me."
Do your best, so that we'll soon see:
Air clean . . . no smog . . . no CFC.
Yes, we all can help to make things be
Some little bit closer to trouble free.

INSIDE:

Its My Turn
 Important Crime Meeting
 MetroRail Update
 Community Phones
 Joe Ennis Party

page 2
 page 3
 page 6
 page 5
 page 12

FROM THE PRESIDENT

It seems as our years go by, they fly by faster and faster, leaving us with so much to do and so few hours. This acceleration of time brings deadlines with amazing rapidity and those of us who regularly have to deal with them are left with the frustration of sometimes not making them. This issue was planned to be out before Thanksgiving, we didn't make it, and this year we committed to four issues of the OVERVIEW – this is the third issue for 1992. So goes the volunteer labor of love. We wish we could do more, but first we make a living.

On the other hand, another type of deadline is fast approaching – that of the holidays. A good deadline, in a sense, since it means gifts and parties and seeing old friends and happy kids and many of the other things that most of us associate with year end and beginning. Needless to say, we all are aware that there are many less fortunate than us – many who are looking at a future too bleak to contemplate, both adults and kids.

At our next general meeting, December 9, we can help some of these people, in a very easy way, by simply bringing items to the meeting to be distributed to the needy by our local law enforcement folks. See the notice later in this issue for details.

— DON WALDROP

NOW ITS MY TURN

By Marcelle Zonta

Ed.: This inaugurates a new feature in the *Overview*: Readers submitting their thoughts. It can be on any subject they feel affects the neighborhood and their place in it. We invite you to submit your turn.

LOST PETS: I have observed many lost pet signs posted in our area. As much as we love our animals, we must realize that by letting them be outside, unsupervised, we put them in great danger. We put them in even greater danger if we leave them out all night. If at all possible, we owe it to them to keep them in at night whether they like it or not. You will rest easier knowing that your companion animal is safe, and besides, let us not forget that ghastly individual who is now poisoning pets in the Silverlake area. Remember, Silverlake is only a hillside away from Franklin Hills.

See **NOW ITS MY TURN** p. 9

**FRANKLIN HILLS
RESIDENTS ASSOCIATION
HOTLINE (213) 664-7247**

FRANKLIN HILLS RESIDENTS ASSOCIATION

BOARD OF DIRECTORS

President

DONALD WALDROP

Vice President

BRYANT CROUSE

Secretary-Treasurer

BRUCE CARROLL

RICCARDO ACCORSI

CHRIS BOUTELLE

GENE CORNELL

CAROL MASON

CHARLEY MIMS

ARNIE NETKA

VIOLET WEBER

FRANK YOGUS

ACTION TEAM LEADERS

ABC-TV & COMMUNITY:

Don Waldrop, 664-4124

CRIME & N'BORHOOD WATCH:

Violet Weber, 663-6427

DISASTER PREPAREDNESS:

Violet Weber, 663-6427

ENVIRONMENTAL:

Marcelle Zonta, 664-4124

GRAFFITI:

Isabel Dietz, 661-4531

L. I. L. A. (French American School):

Don Waldrop, 664-4124

MEDIAN:

Riccardo Accorsi, 666-2431

MEMBERSHIP:

Gene Cornell, 663-2533

METRO RAIL:

Bruce Carroll 665-9875

NE-TACC:

Patti Harrison, 662-8709

PLANNING & ZONING:

Charley Mims, 665-8239

Franklin Hills OVERVIEW

Publisher & Editor: Don Waldrop

Copy Editor: Carol Mason

Contributing Writers:

Riccardo Accorsi, Bruce Carroll,

Violet Weber.

Copy Input:

Carol Skinner

Editorial and Advertising Sales:
(213) 664-4124

The Franklin Hills OVERVIEW is published on an occasional basis. We invite your comments on matters relating to articles and the community and, space permitting, will publish letters mailed to Editor, OVERVIEW, Box 29122, Los Angeles, CA 90027

MEETING ANNOUNCEMENT

HOW SAFE DO YOU FEEL?

by Violet Weber

How safe do you feel? At home? On the highway? Is crime in our city up or down?

These and the other hundred of your questions will be answered at the Franklin Hills Residents Association meeting in conjunction with the Northeast Police Division on December 9th. The meeting will be held at the French American School, 4555 Russell Avenue, from 6:45 to 9:00 P.M.

In accordance with FHRA's long-stated intent to expand the Association's services to provide both current and lasting benefits, the Association intends to present four general meetings on an annual basis. The first for this season, held on August 12 to explain the Disaster Preparedness Program, was well attended and appreciated. This current Crime meeting is intended to give all of us the ways and means of protecting our lives and our property.

Co-sponsored by FHRA and the Franklin Hills Community Patrol, the meeting will focus on the role of the police with the community. LAPD's Northeast Division,

represented by Paul Afdahl, our senior lead officer, will delineate the new measures being set out by Police Chief Willie Williams as well as new, intensive training programs in which the police are engaging.

Other relevant points of interest are the community policing plans, new volunteer programs, and, as an aftermath of the terrible Spring riots, what the community can or cannot do to protect themselves if left to ourselves as we were those few terrifying days and nights.

The meeting will be facilitated by FHRA Vice President, Bryant Crouse, and the second half of the meeting will be open to questions and answers from the audience. There will be an opportunity to meet the officers who are assigned directly to our neighborhood. In addition, we will have a chance to meet Captain Wemmer, new to our area, and to find out more about the inner workings of our Northeast Division.

Refreshments will be served.

GIVE THE CHRISTMAS SPIRIT

The very spirit of Christmas is in giving. And, as some sage said, "If you want to do something for yourself, do something for somebody else.

Many families are suffering because of the difficult economic times. Every year the Northeast Police Division collects toys and foods for families who have been referred to them as being very needy.

When you come to the GENERAL MEETING on CRIME on December 9, please bring along some toys and non-perishable food and give them to the police officers who will be conducting the meeting. Or, you may call the Hot Line of the Franklin Hills Residents Association, (213) 664-7247, and arrangements will be made to pick up your contribution.

Don't let this Christmas go by without making it a little happier for someone else. It will bring the Christmas spirit into you life as well!

Don't forget, bring your contribution with you to the Crime meeting December 9, at L.I.L.A., the French-American school, 4155 Russell Street, 6:45 to 9:00 P.M.

JOIN FHRA — See page 23 for Details and Membership Form

Disaster Preparedness:

ARE WE DOING SOMETHING WRONG?

Your Disaster Preparedness Program has been in place now for two years. Two seven-week classes have been held, five response teams are in place and programs have been presented to help you know what to do and where to go to get help in case of a disaster—any disaster.

All these plans are in place. We continue to meet, to plan, to practice. Unfortunately, implementing plans and stocking our storage areas with medical supplies, food and water takes money. We have \$500—we need \$2500 as a minimum.

We have begged—even pleaded and cajoled, but we cannot seem to get above that \$500 mark which will buy only a modest amount of medical supplies.

It is my hope that you, our neighbors will respond to the very real need for disaster preparedness supplies—after all, they may save your life or that of someone you love.

We need fire extinguishers, two medium size generators, walkie talkies, shovels, crow bars, flash lights, clean blankets, chain saws, crowbars. But most of all, we need MONEY. Money isn't in copious supply right now but the tragedy of a life lost because of lack of supplies would be unforgiveable.

This is also an appeal for those who attended the August FHRA Disaster Preparedness meeting to return the "Confidential Questionnaire" which was distributed. This questionnaire evaluated the community resources which we might be able to call upon as well as giving us information we might need in order to rescue trapped persons or pets.

We ask for your support. Send a check for our disaster supplies to:

**FHRA, Disaster Fund,
P.O. Box 29122,
Los Angeles, CA 90027.**

For Additional Information: Violet Weber, (213) 663-6427

needs & wants

LOS FELIZ LIBRARY

Volunteer TUTORs are needed for a tutorial program, estimated time per week: 2-3 hours.

Donations needed: Books and videos to sell, patio furniture, indoor plants and watering can, outdoor planters and plants.

The Los Feliz Library is begin-ning a rental program with multiple copies of books taken from the best seller lists. The books will rent for 10 cents a day, with no reserves being taken. PROJECT BESTSELLER is being funded by the Los Feliz Friends of the Library.

The Library has urgent need of a working typewriter. If you can donate one, please call.

CONTACT: Thea March,
Los Feliz Library, 1939 1/2
Hillhurst Avenue, (213) 664-
2903

TUTORS

Volunteers to tutor little kids or big kids, in reading, math or writing skills. Community tutoring corps are forming now. If you want to help a youngster succeed in life, call 413-4221.

JOBS / APPRENTICESHIPS

If you need help in your business or home and are willing to employ, train or apprentice local teenagers, call 413-4221

• community phones •

IMPORTANT COMMUNITY PHONE NUMBERS

ABC-TELEVISION:

John Yingling, Plant Manager, (310) 557-5000
Security: (310) 557-5354.

CITY ANIMAL REGULATION: (213) 222-7138

COUNCILMAN JOHN FERRARO, 4th District:

Room M-30, City Hall, 200 Spring St., (213) 485-3337
District Office, 625 S. New Hampshire (213) 485-4377

ENVIRONMENTAL:

Recycling: (800)-CITYSAN

Rebate for Ultra Low Flush Toilet installation.
(213) 481-5800; (800)-722-1122

Rebate for Super Efficient Gas Water Heater.
(800) 852-9820

Hazardous Waste Hotline (213) 237-1634

FIRE DEPARTMENT: Emergency 911;

Non-emergency: 485-6235;

GRAFFITI:

On private property: (213) 253-2687

On public property: (818) 772-7753

FHRA Graffiti Action Coordinator: (213) 661-4351

LOS FELIZ PUBLIC LIBRARY: (213) 664-2903.

Hours: Mon-Tues 12:30-8:00; Wed-Thurs 12:30-5:30;
Fri-Sat 10:00-5:30.

PARKING ENFORCEMENT DISPATCH: (818) 904-1418

POLICE: Emergency 911;

Northeast Division: Non-emergency (213) 485-2563

RECYCLING INFO: (800) CITY SAN

SANITATION: (213) 485-4906

STREET LIGHTING: (213) 482-5483

STREET MAINTENANCE: (213) 485-5661

TELECOMMUNICATIONS: (TV Cable service) 485-2751

TRASH RECEPTACLE INFO: (800) 248-9726

WATER & POWER: (800) 722-1122

FHRA HOTLINE

The Franklin Hills Residents Association reminds you that we now have our own telephone number. By calling **(213) 664-7247**, you can leave messages for board and committee members, make suggestions, or ask questions.

It's not exactly a "hotline," and getting an "800" number didn't seem to make much sense, so we hope you find our plain old neighborhood number useful.

The only problem with 664-7247 is that, so far, we haven't figured out anything clever and meaningful that it might spell. We missed by one digit getting the initials FHRA. To remedy this problem, we will offer anyone who decodes the right hidden message in 664-7247 a beautiful Franklin Hills T-shirt.

FHRA HOTLINE (213) 664-7247

WARNING!

There have been numerous thefts of both incoming and outgoing mail in the Franklin Hills area recently.

To find out what to do:

COME TO THE CRIME MEETING,
WED., DEC. 9th, 6:45 p.m. - 9:00 p.m.
French American School
4155 Russell Avenue

GRAFFITI ALERT

Plans are being made for another FHRA community paint-out. If you would like to be involved or if you know of a trouble area, call Isabel Dietz: 661-4351.

Patronize "Our" Businesses

Traveling to other areas to shop has become troublesome now that the population and traffic have increased so much.

The businesses that have shown interest in reaching you and your neighbors by advertising in this volunteer produced, hand-distributed, newsletter are charged the absolute minimum possible advertising fees. Their ads pay for the paper and any surplus goes to FHRA.

Please support our advertisers by utilizing their services regularly and, by all means, tell them you saw their ads in the "Overview."

MetroRail:**SIGNS OF PROGRESS**

By Bruce Carroll

On October 2nd, a bit tardy for the promised September date, Metro Rail work crews started turning the entrance of the Barnsdall Art Park into a construction site. Their hand lettered signs were probably less an effort to blend in with the artistic theme of the park than a failure to plan ahead. Neighborhood complaints of excessive dust highlight the same failure. Red Line spokesman Kathy Jones Irish explained, "We are going to be wetting down the area to make sure the dust is controlled . . . we did have a problem because our DWP [water] hookup was not completed in time." That wasn't the only utility snag. Workers preparing the tunneling site also cut through telephone and power lines serving the park.

By press time the park entrance was once again open with new signs welcoming the wary. Come spring these minor glitches will surely have given way to the major problem, excavating 12 miles of tunnel from Vermont and Wilshire to Hollywood and Highland. Let's hope Metro Rail's sense of direction is better than their signs, or we could all be surprised by a giant drill emerging



Since these signs were drawn, Barnsdall Art Park Museum employees have reportedly agreed not to dig tunnels if MetroRail construction workers won't make anymore signs.

somewhere along Prospect Walk. The tunneling will take until 1996.

By 1988 Metro Red Line subway trains from Sunset and Vermont will whisk you to Union Station in about 20 minutes, if you can find a place to park. The FHRA has written to Rail Construction Corporation President/CEO Ed McSpedon decrying the absence of Park-and-Ride facilities at Metro Rail's Hollywood stations. McSpedon, always looking for business, replied, "I applaud your members' interest in becoming future

**FRANKLIN
HILLS
RESIDENTS
ASSOCIATION**

**HOTLINE
(213)
664-7247**

MISTO Los Feliz

RESTAURANT AND ART GALLERY

Misto: a mixture of the cuisines of Italy, the American Southwest and the Caribbean

**2064 Hillhurst Avenue • Los Feliz Village
(213) 667-1357**

**BAYLESS
CHEVRON SERVICE**

1869 N. Hillhurst (at Franklin Avenue)

Seasons Greetings

TED BAYLESS

665-9837

**BALLER
HARDWARE**

2505 HYPERION AVENUE

(213) 665-4149

patrons." He's asked Judy Wilson who, "... directs planning issues that occur around Metro Subway stations . . . to work with you and your membership to identify a mutually agreeable solution to your request." However, the weeks have gone by with no contact from Ms. Wilson . . . we shall see.

One solution, already in place, is to park free at the Glendale Amtrak station and head downtown on one of Metrolink's seven weekday trains between 6:05 A.M. and 8:15 A.M. According to spokesman Brendan Shepherd, "The cars are quite special. They're double deckers. They're air-conditioned, have individual seats, bike racks and cellular phones." But don't count on breakfast during your 25 minute ride, Shepherd warns, "there's no food service." Once you get to Union Station, free shuttles will convey you to the Civic Center, Bunker Hill area, or to 9th and Hope and the financial district. People heading there should have no problem paying (\$3.50 one way / \$6 round trip, \$80 monthly) for rail tickets from ATM style vending machines.

There is potential good news for non early risers. "Maybe six to eight months into it we'll reevaluate and it's quite possible we'll add midday, reverse commute (through Burbank to Moorpark and Santa Clarita) and also evening service." Spokesman Shepherd was even tooting his horn for the diesel locomotives that pull the 3-car, 444-seat, 150-standee, trains. "They are the cleanest burning locomotives available. They

You'll be proud to wear this t-shirt with its classically designed graphics that show the Shakespeare Bridge and a silhouette of our historic Franklin Hills.

The t-shirts are a crisp white heavy-duty 100% cotton and the graphic design, printed in rich teal and purple, is donated by the international award winning designer and Franklin Hills resident, Eugene Cheltenham.

All proceeds from the sale of the shirts go to help fund the Franklin Hills Residents Association's efforts to preserve and enhance the neighborhood.

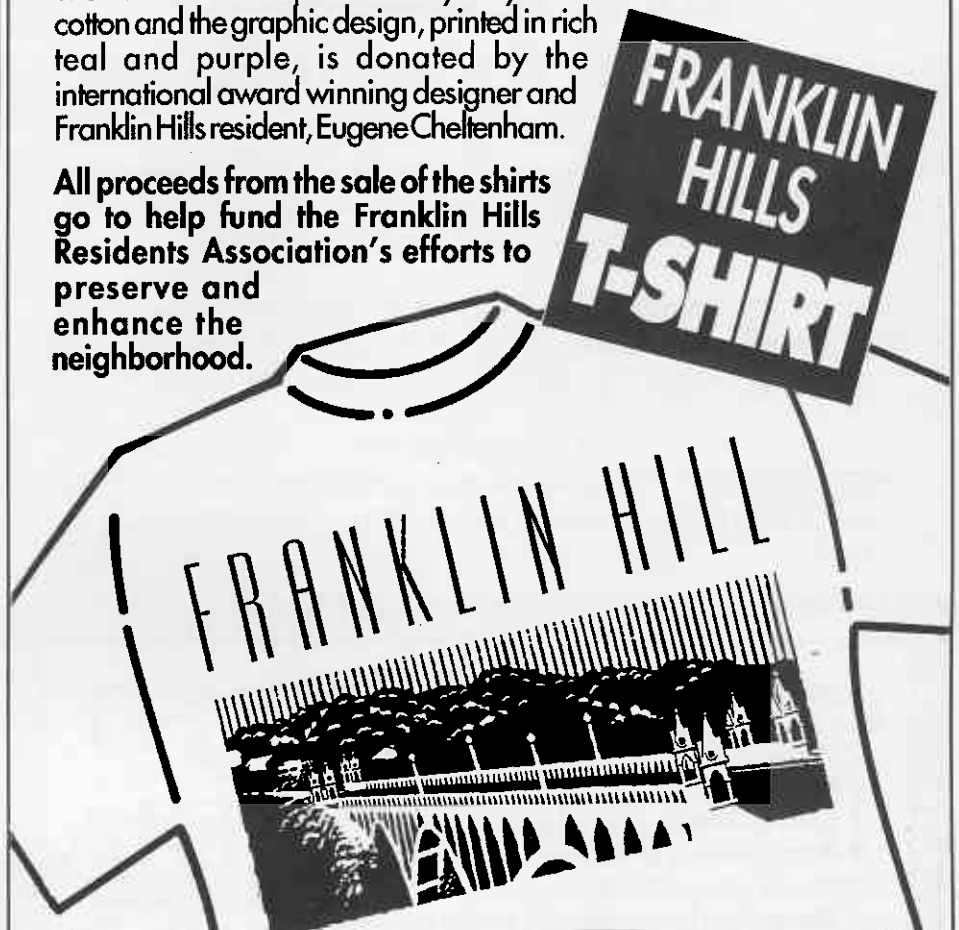

ORDER FORM

1 T-SHIRT
\$12.00

2 T-SHIRTS
\$22.00

3 T-SHIRTS
\$30.00

MAIL TO: FRANKLIN HILLS T-SHIRT
P.O. Box 29122, Los Angeles, CA 90027
MAKE CHECKS PAYABLE TO:
Franklin Hills Residents Association
(Do not send cash.)
T-shirts subject to availability.
Please allow 2 to 4 weeks for delivery.

NO. OF SHIRTS			PRICE	
M	L	XL		
			POSTAGE & HANDLING	\$2.00
			TOTAL	

NAME _____

ADDRESS _____ APT. _____

CITY _____

STATE _____ ZIP _____

PHONE _____

FRANKLIN HILLS RESIDENTS ASSOCIATION MEMBER?: YES NO

T-shirts printed by Hollywood Graphitee - (818) 776-8044

HOUSEHOLD HAZARDOUS WASTE ROUNDUP DON'T LET L.A. GO TO WASTE

Throwing away household chemicals with the regular garbage or throwing them down the drain damages our environment and is against the law.

Household chemicals in your home can also pose a threat to you and your family. Let the City of Los Angeles Bureau of Sanitation dispose of these chemicals properly.

They will accept
HOUSEHOLD CLEANERS, AUTOMOBILE PRODUCTS,
PESTICIDES, PAINT, OUTDATED MEDICINE, etc.

The following regulations apply to this event:

- It is illegal to transport more than 5 gallons or 50 pounds of hazardous waste.
- Please do not bring empty containers or dried-up paint.
- Please transport waste in a cardboard box
- Keep all materials away from passengers during transportation
- Keep products in original containers.
- Do not mix products.
- Waste from businesses will not be accepted
- Make sure containers are leakproof; if they are not, place them in larger leakproof containers.
- No radioactive materials, compressed gas cylinders, infectious waste, explosives or ammunition. No business waste
- DRIVE-THROUGH ONLY; no walk-ins. L.A. residents only
- Please stay in vehicle while at the Roundup

HOUSEHOLD HAZARDOUS WASTE ROUNDUP

December 5, 1992

9:00 A.M. TO 3:00 P.M.

U. S. POSTAL SERVICE

15421 Gale Avenue, City of Industry

FURTHER INFORMATION: (213) 237-1634

NOTE: Heavy rain will postpone the event one week.

WHAT WE'RE UP TO

In response to nearly no requests about just what the Franklin Hills Residents' Association's directors so at their board meetings on the 3rd Thursday of each month, Secretary Bruce Carroll submitted the following report:

Last month we worked on plans for the December 9th General Meeting with LAPD. (See page 3) Crime is always a pain in the _ _ _ , butt to alleviate some of that we voted to buy padded, rather than unpadded chairs . . . so come early.

In October, we decided to join with other neighborhood organizations in our area in a Street Tree Beautification Coalition. Working with ABC along the barren stretches of Talmadge is among the initial objectives. In addition to a dearth of trees, the board also pondered the dearth of committee activity by those not already on the board. Anyone out there with some good ideas and a little time . . . or perhaps with no ideas but a lot of time . . . call the FHRA hotline. If you read the rest of this story you'll find the number . . . If you can't wait to volunteer call 664-7247.

In September, we voted unanimously to tell the city we support a traffic light at Hyperion

and Monon, to allow people (and cars) to move more safely between Trader Joe's and the shops around it and Mayfair Market and the shops around it. The board also supported proposed bike paths on Griffith park Boulevard where it parallels Hyperion.

And for those who prefer to exercise their minds, we appointed a committee to look for ways to support the Los Feliz Branch Library. Their first act was to donate 10 special dictionaries to the library's literacy program. We also heard that official papers requesting the FHRA be appointed a nonprofit organization have been received by the bureaucrats.

In August the board goofed off and didn't meet, but Vi Weber and her committee worked hard on the very helpful and successful Community Disaster Preparedness meeting.

In July the board discussed: the purchase of CB radios so our disaster team leaders can communicate in a

Please see **WHAT WE'RE UP TO**, p. 22



THE STATE OF ART

paintings • sculpture • fine prints • folk art

THIRD WORLD ART EXCHANGE

features the finest in Third World and African American art . . . art with cultural and artistic value. The walls are alive with the exquisite works of acclaimed and internationally recognized artists.

GALLERY HOURS:

Wednesday through Saturday 11:00 a.m. to 7:00 p.m.
(The gallery is closed weekdays from 2:00 to 4:30 p.m.)

2016 NORTH HILLHURST AVENUE
LOS FELIZ VILLAGE, LOS ANGELES, 90027
(213) 666-9357



MY VIEW

by Bruce Carroll

It is more efficient...but takes more time?
 It is automated...but takes more manpower?
 It helps the environment...but creates more pollution?
 and one final hint:
 It happens every Thursday in the Franklin Hills.

??????????

The answer to the *Overview* riddle of the month: our new garbage collection system, of course.

Back in simpler times, say a year ago, Vernon Adams singlehandedly managed to drive his garbage truck around the Franklin Hills, stop at each cluster of cans, and personally to heft them into the hopper. On our narrow streets he was able to do both sides in a single trip.

When recycling came our way most of us happily put bottles, cans and newspapers into our new yellow boxes. But recycling is obviously very difficult, so the recycling bandwagon we were eager to get on turned out to be a second truck, requiring two men. One man drives while the other decides if the contents are worthy of recycling. He rejected

last year's phone books, for example.

Then came real automation. Behemoth wheeled cans now decorate our curbs Thursday mornings (and in some cases all week.) With a magic can picker-upper mounted on the right side of his garbage truck, a much relieved, especially in the back, Vernon Adams now doesn't have to touch those heavy dirty cans. But he does have to drive twice as far, going up one side of the street and down the other. He says that takes about 30-45 minutes longer, but "it's a lot easier."

Now we all know the refuse of life in our throw-away society doesn't always fit into just two cans...even really big ones...so we need extra cans for the contents of that closet we should have cleaned out years ago; and we stack bags of clippings (which we should compost) from that jungle where the back yard used to be. Because the truck with the magic picker-upper is sort of a let down when it comes to these problems we also need the "sweeper truck". It zips about the neighborhood with two tough guts aboard looking for the stuff the other trucks just couldn't handle.

So, where we used to manage with one man, one truck, one trip, we're now blessed with five men, three trucks, four trips, and it takes longer. But there are some advantages. The money strapped city now spends over 50 bucks apiece to give us garbage cans, and more importantly if I hear that clank and clatter in front of my house before I finish squeezing my morning orange juice I still have plenty of time to throw the peels away. I can use the can across the street. •

ART-n-Barbee
 2070 North Hillhurst Avenue
 (213) 660-5145
 BBQ and AFRICAN FOOD
 ART GALLERY
 POETRY and LIVE MUSIC
 11:00 a.m. to 10:00 p.m.
 Delivery - Catering
 (sweet potato cheesecake & peach cobbler)

CAROL'S CRITTER CARE
 PET CARE WHILE YOU ARE AWAY FROM HOME



BONDED AND LICENSED (213) 660-3846

bella bella
 a beautiful boutique

Don't waste a moment driving when you can shop in the neighborhood

2066 hillhurst avenue
 los feliz village • 662-7747

WOOD-REVIVERS

RE-BEAUTIFY AND PROTECT ALL INTERIOR AND EXTERIOR WOOD

- Decks
- Fences
- Cabinets
- Hardwood
- Gazebos
- Sidings
- Furniture
- Floors

Affordable Convenient Service • Earth Safe Products
 (818) 398-4389



Vitagraph Studios, present home of ABC Television Center, at the corner of Prospect Avenue and Talmadge. Photo undated but taken in the early 1930's.
(Security Pacific National Bank Photograph Collection/Los Angeles Public Library)

Silver Lake Iron and Concrete Works

2025 hyperion avenue los angeles, california 90027
(213)663-8245

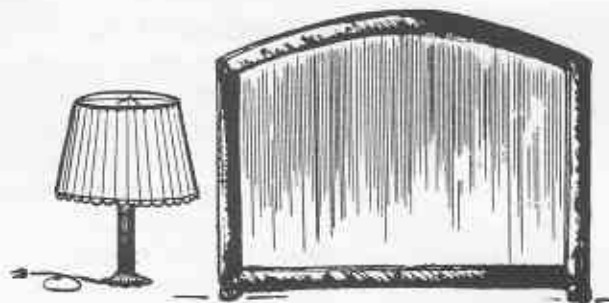

The Lyric Avenue Bedside Lamp and the Hesby Street Firescreen, good gifts for people who are stubborn about things like lamps and firescreens. Place your custom order now for Holiday delivery.

To place ORDER, receive MAILER, or see our PORTFOLIO of large and small scale ironwork for the home, CALL (213) 663-8245

Carolyn's Restaurant

AND CATERING SERVICE

*A Unique International Restaurant & Cafe Offering
Something Special To All Five Senses*

- Taste** EUROPEAN & AMERICAN HEALTHY DISHES AT REASONABLE PRICES
- Sight** NEW WORKS OF ART BY NEIGHBORHOOD ARTISTS ON DISPLAY (6 to 8 weeks)
- Sound** BACKGROUND JAZZ & BLUES MUSIC
- Smell** THE AROMA OF FRESH GARLIC & HERBS FROM AROUND THE WORLD
- Touch** THE AURA OF FRIENDLINESS & BEING FAMILY THAT GREET'S YOU AT THE DOOR

*Complete dinner
Nothing Over \$8.50*

Fresh Quiche • Salads & Soups • Lucious Desserts
Ice Creams • Full Espresso & Cappuccino Bar
Sandwiches • Vegetarian & Healthy Meals
Breakfast Anytime
Vegetarian • Italian • Southern & Such
Call for Daily Specials

Hours: 8:00 a.m. to 8:00 p.m.
2520 HYPERION AVE. • LOS ANGELES
(213) 664-2405

WATERWORKS PLUMBING

RESIDENTIAL COMMERCIAL
INDUSTRIAL

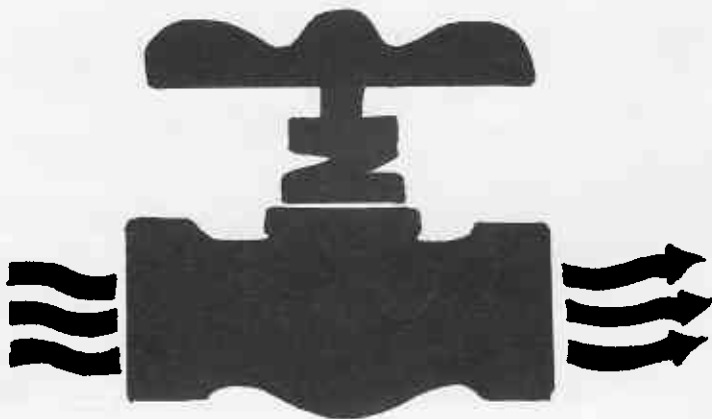

YOUR NEIGHBORHOOD PLUMBER
NO JOB TOO LARGE OR TOO SMALL

(213) 913-3893

JEVON M. PAUL
4119 CUMBERLAND AVENUE
LOS ANGELES, CA 90027

CALIFORNIA STATE LICENSE NO. 623933

JOE ENNIS

For all of those who have ever griped about the competence of government employees, it would have restored their faith if they had attended the recent retirement party for Joe Ennis, the affable postman who has served the Franklin Hill for the past 13 years.

The only complaint ever made about the friendly postman was that he was later than the others because he had so many friends on his route that by the time he has stopped for a cheery hello, his day became longer and longer.

He was honored by a well-attended patio party at the home of Mrs. Violet Weber in late September. Joe was presented with an honorary plaque from the City of Los Angeles for his long service, presented by Council President John Ferraro's first deputy, Tom LaBonge. LaBonge praised Ennis' long years of service and urged others in the postal service to take him as a role model. LaBonge also noted his own resignation from Ferraro's staff to run for Councilman in the Thirteenth District.

Ennis received another plaque, making him an honorary member of the Trojan Family for having been one of USC's most enthusiastic boosters. The plaque, from the office of USC Vice President Shari Thorell, was presented by alumna Carol Skinner.

Many other gifts and cards, as well as a very substantial community-contributed cash gift, were presented to Mr. Ennis as a token of the esteem in which the Franklin Hills neighborhood holds him.

Nearly one hundred people crowded the patio on DeLoz Avenue, and a committee consisting of Carol Skinner, Dorothy Jean Hartshorn, Marcelle Zonta and Violet Weber served Mexican hors d'oeuvres and champagne, and Vivien Shea capped the afternoon with four home-baked cakes for dessert.

It was not only a party to honor Mr. Ennis but also a chance for the neighborhood to get acquainted with each other and, hopefully, will stimulate more block parties in the years ahead. •



ABOVE: Joe Ennis is presented a Los Angeles City plaque by Tom La Bonge, Councilman Ferraro's Deputy, honoring Joe's service to Franklin Hills. RIGHT: Joe is overcome with poetic ecstasy after Bruce Carroll's song: "Lay Down Your Bag, Joe Ennis" to the tune of "Hang Down Your Head, Tom Dooley."



WELCOME TO THE NEIGHBORHOOD!

NEWLY OPEN ON HILLHURST

**Chef Pierre's
LE PETITE MARKET**
(Deli - Continental Breakfast - Bakery)

EAST SIDE RECORDS (913-7461)
(New and Used CD's, Records and Tapes)

MISTO Los Feliz
(Italian-Southwest-Caribbean Restaurant)
(667-1357)

NEWLY OPEN ON HYPERION

SIMPLY UNIQUE
(Collectibles / Gifts) (661-5454)
SABOR
(Restaurant) (660-0886)

**TRY THEM ALL! SUPPORT OUR
NEIGHBORHOOD BUSINESSES!**

LOOKING FOR A BETTER CHIROPRACTOR?

A
DOCTOR
WHO:



- Takes the time to thoroughly evaluate.
- Personally delivers all therapies.
- Includes in-office exercises and therapies
- Is currently a post-graduate instructor (teaches other doctors)

JERRY HYMAN, D.C.

2525 HYPERION AVENUE
(213) 660-0771
please call for appointment

*Grand
Opening*

Chef Pierre's Le Petit Market

*1801 Hillhurst Avenue
(in Los Feliz Plaza)*

New York Style

• **Delicatessen**

soups, appetizers, salads, sandwiches,
gourmet dinners to go, desserts

• **Continental Breakfast**

Bar - espresso, fresh fruit & juices,
fresh pastries from the bakery

• **Bakery**

brioche, baguettes, homemade muffins,
danish, bagels & croissants

Complete

Holiday Dinners

(Roasted Turkey, chestnut dressing, giblet gravy, &
pumpkin pie)



also

- Gourmet Gift Baskets
- Catering
- Party Platters for all occasions
- Pre-arranged deliveries

to order call

213-661-1914

Market Hours

8:00 a.m. - 7:00 p.m.

(formerly Yellow Ribbon Market)

Median, from p. 1

solicited from licensed landscape contractors for the installation of the irrigation system only. This will provide a professional system and warranty for what is arguably the backbone of the Project. Reducing the technical aspects and risks of the installation will allow the volunteers to concentrate on the enjoyable work of the actual planting.

Proceedings have begun with the Department of Water & Power to have a water meter installed, at a cost of \$1,315 and there is a frontage charge of \$20 per foot, in addition to the actual cost of installing the meter. The DWP originally deemed the frontage to be 200 feet (\$2000) though the median is actually 411 feet long. Fortunately, "frontage charge," being one of those fees which no one ever seems to know exactly how to define, can change and it did. The DWP agreed to calculate the frontage as a factor of the median's width instead of its length. But according to the inexact science of these pervasive fees, DWP deemed the width to be 14 feet instead of the actual 11 feet. Well, we won't get upset about that at this point. However, the City's Department of Public Works will be approached and asked to pay for the installation fee and the monthly water bill from a fund established to maintain medians throughout the City. After all, it is City property, and it is the people of our community doing beautification work which will reflect well upon the City's governing bodies.

FHRA is very excited with the momentum the Project has picked up and we are hopeful that the funds will be gathered before this year draws to a close. It is up to all of us to continue to spread the word and to put a little bit of our private self back into the public entity. Any amount that you can pledge will help fill the blank cartridge so the Project can carry out its race. A big bang for the buck is virtually guaranteed!

See **Design Drawings** on p. 16

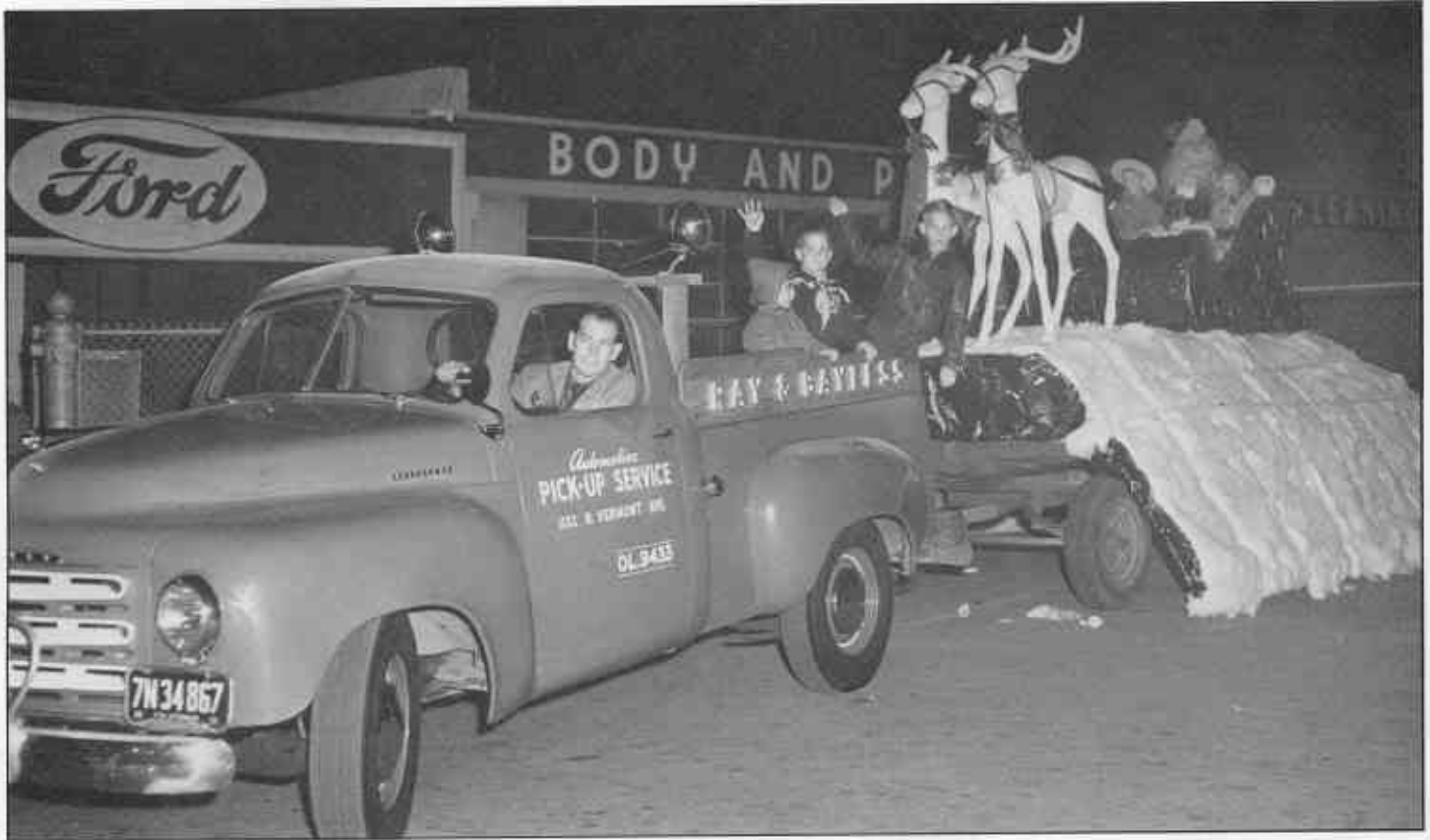

Shown ready for the December 1950 Christmas Parade, sponsored annually by the Vermont Avenue Merchants Association, is the Bayless Santa Claus float, driven by Arnie Bayless and accompanied by the Bayless children, Carolyn, Ted (now owner of Bayless Chevron) and Bud.

BOOKS PLUS

your new neighborhood
book store

THE BEST SELECTION OF PAPERBACKS
& MAGAZINES YOU'LL EVER FIND

Next to Video Journeys
2724 Griffith Park Blvd
(213) 660-6035



WEDDING & OCCASION CAKES

\$1.00 OFF PIES & CAKES; \$2.00 OFF CUSTOM CAKES
with this coupon only

1911 HILLHURST AVENUE, LOS ANGELES, CA 90027 (213) 664-0805



VIDEO JOURNEYS

Largest videotape and
laser disc selection in
Los Feliz and Silver Lake

2728 Griffith Park Boulevard - (213) 663-5857

JOIN
FHRA

FRANKLIN AVENUE MEDIAN PROJECT

DESIGN AND DRAWINGS BY RICCARDO ACCORSI



FRANKLIN AVENUE

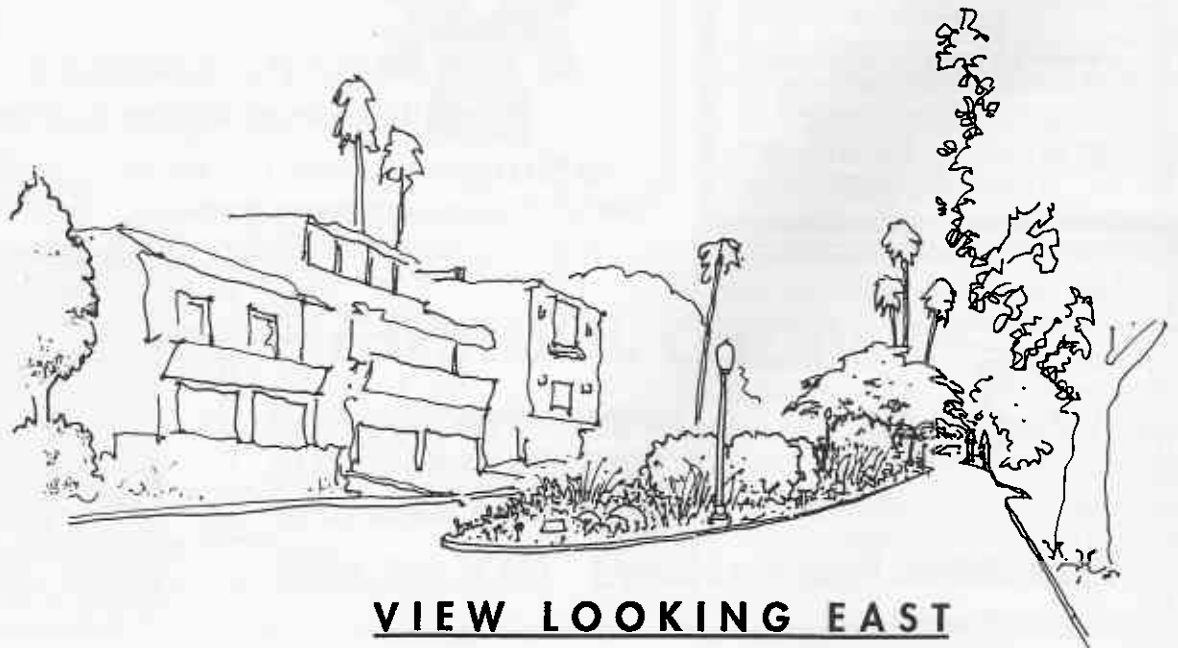

VIEW LOOKING EAST

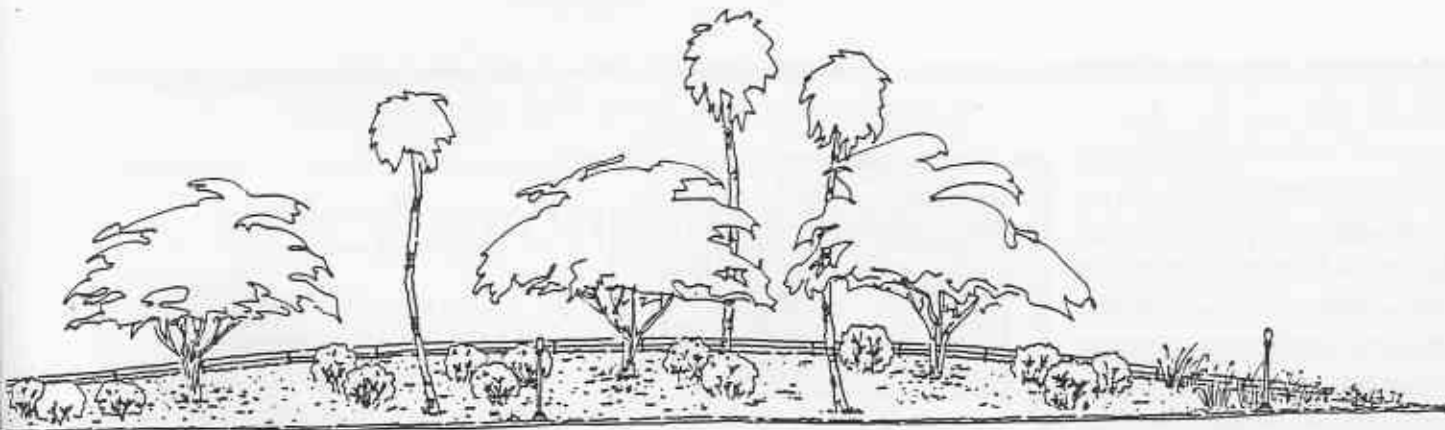

ELEVATION VIEW

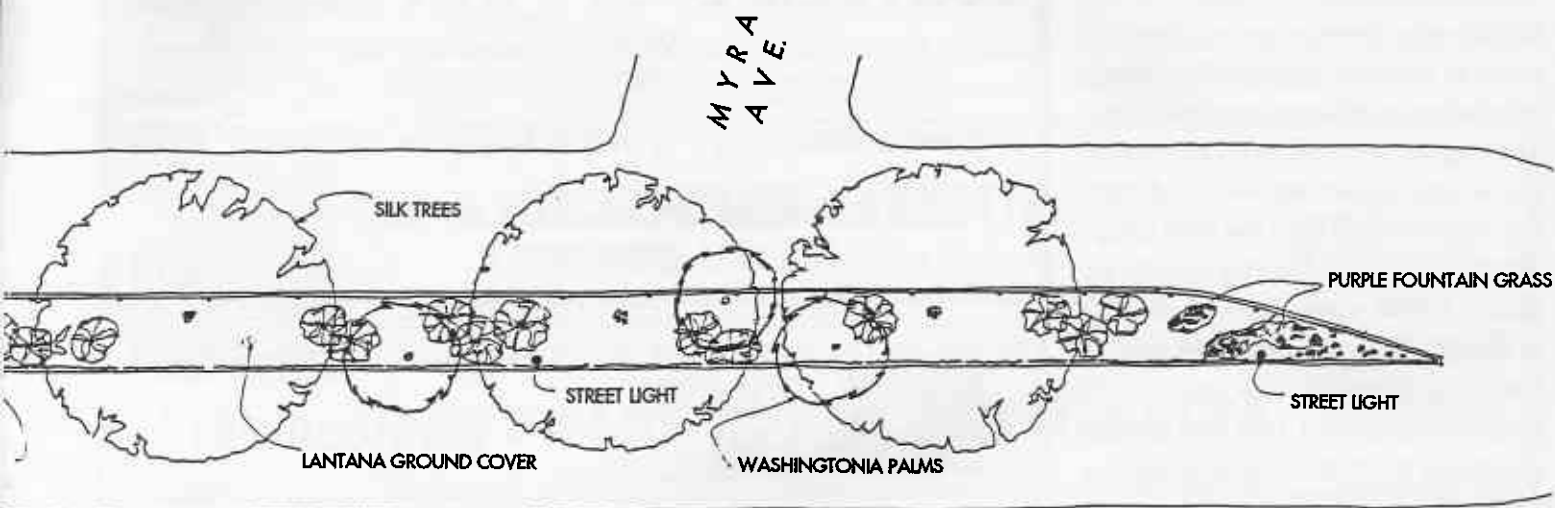

PLAN VIEW

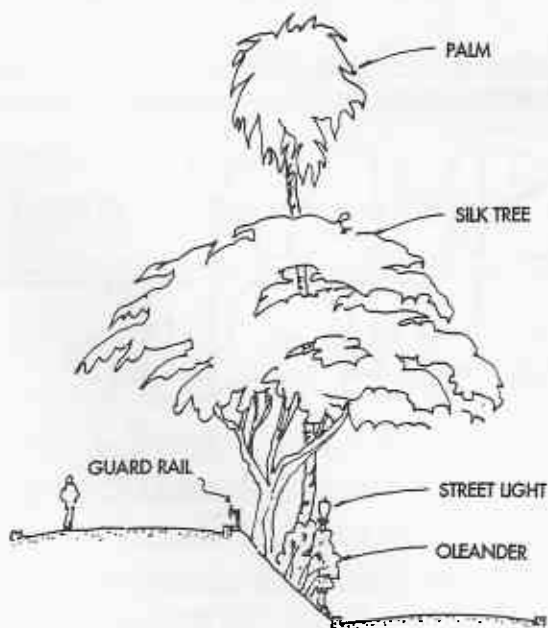

CROSS SECTION



VIEW LOOKING WEST

NOW ITS MY TURN, from p. 1

RTD BUSES: The RTD, better known to the folk like myself, who take the #26 into downtown LA, as "Rotten Transit District," is definitely not serving the people of this area. I do not know about the other buses, such as the one on Talmadge or Hyperion, but I sure would be interested to know if those buses run as infrequently as the #26 and are as undependable.

Some folk take the bus because that is their only means of getting from one point to another. Others, like myself, take the bus because we hate driving into Los Angeles every day and dealing with the outrageous parking cost. The posters beg us to take the bus; the RTD weeps about the shortfall, yet they seem to try to make the bus experience as unpleasant as possible. Several times in the last few weeks, the 7:11A.M. into Los Angeles from Hillhurst and Franklin has not shown up at all, making us all late for work. This is not good enough.

And that's just the morning. In order to catch the #26 going back into our area, one has to stand on one of the many unpleasant corners in downtown Los Angeles, waiting for what seems like forever. We see many buses going to Santa Monica, many going to the Valley and all other suburbs, but where is the #26? Nowhere to be found. When it does show up it is usually so horribly packed that it just goes zooming by and we all stand there waiting for the next one which usually comes, if we are lucky, about 30 minutes later.

When I wrote a letter complaining of the terrible service this area seems to get, they sent me a letter happily stating they were thinking of adding another #26 in the evening that would come to



CHILDREN'S • BOOK • STORE

2640 GRIFFITH PARK BOULEVARD, LOS ANGELES, CA 90039
213 • 668 • 1996

Mon - Sat: 10am - 5:30 pm
Sunday: 12 noon - 5 pm

TODDLER STORY TIME
1st & 3rd Wednesday each month

LOS FELIZ LOCK & KEY SERVICE

- 24 Hour emergency service • Auto lock specialists • Locks installed •
- Combinations changed • Master Keying • Residential • Commerical •

Season's Greetings to our friends in Franklin Hills

1856 N. Vermont Avenue, South of Franklin Avenue
663-8351



(213) 660-9811

**1943 Hillhurst Avenue,
Los Angeles, CA 90027**

**Call Us For All Your
Travel needs. Enjoy the
Luxury of Full Service**

Discover

**SIMPLY
UNIQUE**

- GIFTS
- COLLECTIBLES
- ANTIQUES
- LIGHTING
- JEWELRY
- FURNITURE

Beautiful things at
very reasonable prices

Tues thru Sun: 12 noon to 7 p.m. - Free and safe offstreet parking
1903 HYPERION AVENUE - SILVERLAKE 213/661-5454

Know Anyone...

who wants to own
property in
Franklin Hills?



1740 Deloz Ave.
\$316,000

Call Me!

Terrel Miller Yeager

Broker Associate
213 656-8400 213 662-9988

Fred Sands



Never stop Moving!

our corner at 5:45 P.M.. Excuse me, we get off work at 5:00, all we want is a bus there at a reasonable time. We want to be able to depend on a bus being there without having to wait long periods of time on unsafe corners in Los Angeles. A person can accept not being able to sit down on the bus, or that the bus is dirty, but at least be dependable. When I see the so-called "Bus Rider's Bill of Rights" in the bus I just want to laugh. What is it with the RTD? Don't they think that we need public transportation just because we live in the hills, or do we just not matter? I wonder. •



FRANK BOYLE

I DELIVER RESULTS!

- 2073 Mayview Drive sold in six weeks.
- Participated in sale of 1918-1920 Talmadge.

JOIN WITH ME AND THE #1 REAL ESTATE BROKER IN OUR AREA*

CALL FRANK BOYLE, GET RESULTS

(213) 665-5841
(213) 466-6177



This is not intended as a solicitation if your property is currently listed with another broker.

*C.L.A.W./N.L.S. 4/92

PALERMO

R I S T O R A N T E I T A L I A N O



Delicious Italian Cuisine In The Old World Tradition

OPEN DAILY 11:00 a.m.

CLOSED TUESDAYS

1858 N. VERMONT AVENUE, LOS ANGELES (213) 663-1178 and 663-1430

SUNRISE PET AND FEED

A complete line of pet supplies and food for all animals

(213) 665-2215

4327 Sunset Boulevard
Los Angeles, CA 90029
(across from McDonalds)

15% OFF

Must present this coupon. Limit one coupon per customer.
All purchases except dog food, cat food and birdseed.
Offer ends April 1, 1993 (No Fooling!)

TREE PLANTING COALITION

By Ricardo Accorsi

A coalition to plan and implement the planting of street trees has been formed by the Los Feliz Improvement Association, Franklin Hills Residents' Association and South Los Feliz Community Association. LFIA's Beautification Committee, together with representatives from FHRA and SLFCA, is in contact with the Los Angeles Conservation Corps (LACC), which has highway mitigation funds available for tree planting projects.

In the Franklin Hills area, the coalition has targeted Talmadge Street, among other needy streets, to receive trees, for a few reasons. The first is that Talmadge Street is the common boundary between Franklin Hills and South Los Feliz and, as Talmadge crosses Franklin to the north, it enters into Los Feliz. The cooperative effort will benefit each separate community as well as enhance our continued ability to work together as a larger whole. A second reason is that Talmadge is a collector street having a large amount of daily traffic from our communities' residents and visitors

A practical reason is that the LACC includes Talmadge Street within a master plan for allocation of highway mitigation funds. Without this type of assistance, the tree planting project would have a much smaller chance of being realized. And, finally, ABC Studios' bare

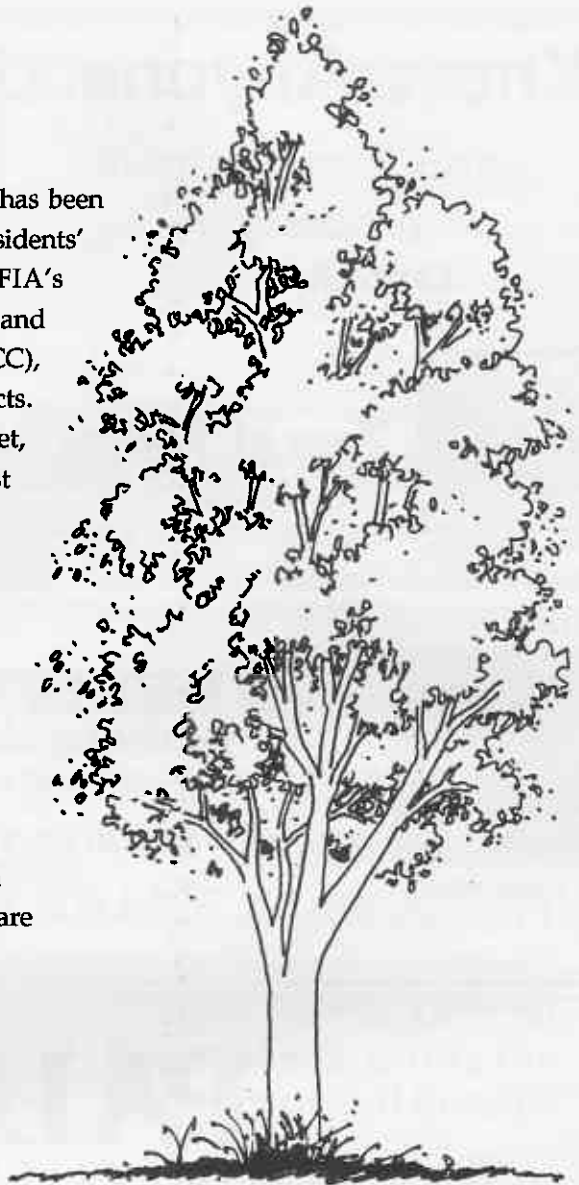

FRANKLIN HILLS RESIDENTS ASSOCIATION HAS NUMEROUS COMMITTEES THAT NEED YOUR HELP.

If you can volunteer some time to any of these committees, please call the Hotline, at (213) 664-7247

Crime and Neighborhood Watch • Disaster Preparedness • Environmental • Graffiti • Median Beautification • Membership • MetroRail • Planning & Zoning • Schools

If you have suggestions of other areas in which the FHRA should be active, please let us know via the Hotline.

DISCOUNT MEDICAL PHARMACY

*most insurance plans accepted
free delivery in local area*

(213) 661-8366

**2718 Griffith Park Boulevard
Los Angeles, CA 90027**

frontage on a large section of Talmadge Street disrupts the residential characteristics of the street. Trees along that length of sidewalk will dramatically reduce the studio's presence upon the street scape. (At the same time FHRA will undertake planning for street trees along ABC's Prospect Avenue frontage without LACC support, since Prospect falls outside of their master funding plan.)

LACC has tentatively scheduled the tree planting on Talmadge Street for March of next year. But there is still a lot of work to be done by the coalition prior to securing LACC's commitment to assist us. A survey will be conducted to identify possible tree locations along both sides of the entire street length. Property owners whose properties could have trees planted in their parkway will be contacted and their commitment to maintain the tree will be solicited. Volunteers from all surrounding areas are welcome and will be needed to conduct the planting marathon, roughly estimated at thirty trees a day for four to six days.

So, if you live on Talmadge Street, keep your eyes out for upcoming information which will require your response. And for all the rest of us, please call the FHRA hotline [(213) 664-7247] if you are interested in participating in the project.

COMMUNITY COMPUTER SERVICES

Is your address book a mess? Got a shoebox full of slips of paper?

Turn it into an individually designed database.

Print outs available: plain paper lists, mailing labels, Rolodex cards, Organizer Inserts, personal address books. Updates at reasonable prices. Call 662-1775

chiropractor:

i.e. fast
relief
from
pain.



DR. RENÉE DAVIDSON CHIROPRACTOR

Call 213-664-6003 NOW
for a FREE CONSULTATION

- LASTING FAST RESULTS
- EFFECTIVE NATURAL TREATMENT
- NO ENDLESS VISITS
- NO DRUGS • AFFORDABLE
- MOST INSURANCE PLANS ACCEPTED



2107 Hillhurst Avenue, Los Feliz Village, 90027

WHAT WE'RE UP TO, from p. 9

disaster, the pros and cons of a new Police Academy on Los Feliz Boulevard (at the old Franciscan Pottery factory site) and a letter requesting park-and-ride facilities at the Sunset -Vermont Metrorail Station.

In June we gave the go-ahead for the wonderful Franklin Hills T-shirts all fashionable residents are sporting and for our FHRA hotline. 664-7247, which helpful and inquisitive residents are calling. If there's a problem you'd like the board to tackle call the hotline and let us hear about it.

-BRUCE CARROLL

**PARTICIPATE!
JOIN FHRA**

METRORAIL, from p. 7

are 40% cleaner than your typical passenger locomotives."

The commute process is reversed at day's end with seven trains leaving Union Station between 4:10 P.M. and 6:20 P.M. Metrolink officials, recognizing a greater desire to leave work than go to it, have made the evening trains to Glendale Station 20% faster. . . cutting the travel time to 20 minutes. On second thought, maybe it wasn't the Metrolink officials, but the engineers who want to get home quickly. •



A great selection of
ROCK CLASSICAL JAZZ BLUES

buy sell trade **CDs LPs TAPES**
T-SHIRTS & POSTERS
1815 Hillhurst Ave. **213. 913 7461**
2 blocks east of Vermont 3 block south of Franklin Ave.

george & associates
REALTORS



**SELLING REAL ESTATE RIGHT NOW IS A DIFFICULT TASK, BUT IT'S NOT AN IMPOSSIBLE ONE!
IF YOU NEED TO SELL, IT'S MORE IMPORTANT THAN EVER TO SELECT THE RIGHT BROKER.**

GEORGE MORENO, Broker/Owner

PROPERTIES LISTED AND SOLD RECENTLY IN THE FRANKLIN HILLS

SOLD SEPT. 9, 1992

SOLD SEPT. 23, 1992

SOLD OCT. 15, 1992

SOLD OCT. 29, 1992



3804 RONDA VISTA PLACE

2389 LYRIC AVENUE

2073 MAYVIEW DRIVE

2242 RONDA VISTA DRIVE

• 2131 HILLHURST AVENUE, LOS FELIZ VILLAGE • (213) 668-7610 •

MEDIAN BEAUTIFICATION QUESTIONNAIRE

Your comments are welcome and will be considered. Please answer the questions to help us determine the viability of the project and return this section to FHRA-Median, PO Box 29122, Los Angeles, CA 90027 or call the FHRA HOTLINE (213) 664-7247 with your answers and suggestions.

1. Do you feel the project is worthwhile?

YES NO

2. Are you interested in participating in the effort to gather resources? If so, in what way?

- Fund Raising
- Coordinating Volunteers
- Planting
- Maintenance

3. Could you make a cash donation?

YES NO

Amount: \$ _____

4. Could you make a material donation?

Item/Value? _____

5. Would you volunteer for the installation?

If so, how many weekend days could you work? 1 2 3 4

6. On a scale of 0 to 5, how experienced are you with planting? 0 1 2 3 4 5 (circle one)

7. Please include any comments or suggestions you feel will benefit the project: _____

Name: _____

Address: _____

Telephone: _____

HOLLYVISTA GRAPHICS

A way to get that flyer, business card, report, menu, letterhead, ad or other graphic item done to your specifications, on your schedule and in your neighborhood. House calls available.
 (213) 664-4124; Fax (213) 664-4192

join
FHRA

RICHARD MACH
 (213) 660-9630

Progressive Properties

Residential and Commercial Investments
 1662 N. Hillhurst Avenue, Los Angeles, CA 90027

FRANKLIN HILLS RESIDENTS ASSOCIATION

P.O. BOX 29122, LOS ANGELES, CA 90027

DATE _____

NEW RENEWAL

NAME _____ TEL (H) _____

ADDRESS _____ TEL(W) _____

- I AM INTERESTED IN: Planning /Zoning Graffiti Crime/Safety Traffic Library Newsletter
 Historic Preservation Environmental Parks Gangs Tutoring Youth Activities ABC-TV
 telephone tree legal membership beautification other _____

DUES are \$20.00 per couple or \$10.00 per person; AMOUNT ENCLOSED: \$10 \$20 \$50 Other \$ _____

Larger contributions are extremely welcome. Thank you for joining FHRA!

FHRA GENERAL MEETING

COME AND BRING YOUR NEIGHBORS
and lots of questions for the

LOS ANGELES POLICE DEPARTMENT

Wednesday, DECEMBER 9, 1992

6:45 p.m. to 9:00 p.m.

**L.I.L.A. (THE FRENCH AMERICAN SCHOOL)
4155 RUSSELL AVENUE**

Entrance to campus one block east of Talmadge on Russell Avenue

HOMEMADE GOODIES



Karen Weiss

A Recognized Professional



(213) 665-1121



Fred Sands

\$348,000

FRANKLIN HILLS OVERVIEW

FRANKLIN HILLS RESIDENTS ASSOCIATION
P.O. Box 29122, Los Angeles, CA 90027

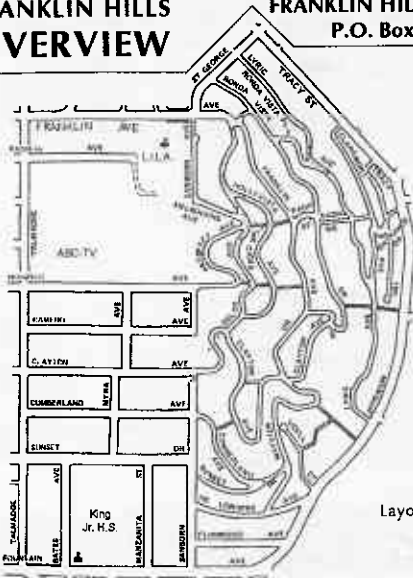

Lithography by PRINCE OF PRINTING
Layout - Design by HOLLYVISTA GRAPHICS



Printed on RECYCLED PAPER